

Diesel generator set B series

with user friendly PS0500 genset controller



Specification sheet

66-112 kW_e, 82.5-140 kVA Prime

Our energy working for you.™



Latest technology product: Value for money

The **Cummins® 'B series'** engine powered diesel generating sets offer the best fuel economy, best warranty terms and lowest cost of maintenance thereby proving to be the most economical power solution. With the superior designed engine and world class Cummins Generator Technologies (Stamford) make alternator, the gensets come equipped with Cummins corporate genset controller for ease of use and monitoring generator performance.

Silent, compact and light weight

The **Cummins® 'B series'** DG sets are smaller and lighter than any other DG set in its class, thus giving you the advantage of optimising your valuable space.

Environment friendly power

The **Cummins® 'B series'** base DG sets are available with the lowest noise levels in its range and are CPCB certified for emissions and noise compliance, thus offering you environment friendly power.



The genset powered by the reliable **Cummins® 'B series'** diesel engine meets stringent exhaust emission tests as per MOEF norms without sacrificing fuel efficiency at normal operating loads.

Unmatched warranty

The **Cummins® 'B series'** DG sets are backed by the industry acknowledged best-in-class comprehensive warranty on the entire package including rubber components.

Lowest operating costs

All elements of the **Cummins® 'B series'** DG sets are designed from the start to work together to maximize efficiency, even at part loads, thus offering you the advantage of lowest operating costs.

© 2009 Cummins Power Generation Inc. All rights reserved. Cummins Power Generation and Cummins are registered trademarks of Cummins Inc. PowerCommand and "Our energy working for you." are trademarks of Cummins Power Generation. Other company product names may be trademarks or service marks of others. Specifications are subject to change without notice.

PGBU/CIL/005/B 75-140 kVA/Jaksons/February 2009/Qty.

Single source power assurance

The rugged and reliable **Cummins® 'B series'** DG sets are unique, because all the major components - the engine, alternator, control system and canopy are manufactured by Cummins India/ Channel partners (Jaksons Limited). This integral approach means each element of a generating set is designed to work in harmony from the start. A high quality product, complemented by the largest customer support network in India, providing round-the-clock service and spares support, offers you **SINGLE SOURCE POWER ASSURANCE** from the world leaders in power generation.

Standard scope

Engine: **Cummins® 'B series'** diesel generating sets, powered by Cummins® 'B series' engines, are rated at 1500 RPM and conform to ISO 8528 specifications. The engines are radiator cooled, four stroke and multi-cylinder, conforming to BS 5514 / ISO 3046.

The scope of supply includes:

- Electrical starter motor 12V DC
- Battery charging alternator
- MICO fuel system with mechanical governor
- Dual spin-on fuel filter
- Turbocharger
- Residential silencer
- Dry type air cleaner
- Shut-off coil with safeties for LLOP/HWT
- Flywheel and flywheel housing
- First fill of lube oil and coolant
- Electronic governor for 140 kVA

Alternator: Stamford alternator from Cummins Generator Technologies, suitable for operation at 1500 RPM, 415 Volts, 0.8 pf (lag) suitable for 50 Hz, 3 phase, 4 wire system, conforming to BS 5000 / IS 4722. The Alternator is brushless type, screen protected, revolving field, self excited, self regulated through an AVR. The alternator has the following features:

- ± 1.0 % Voltage regulation (max) in static conditions
- IP: 23 protection with insulation class H
- Permissible overload of 10% for one hour in 12 hours of operation



Mounting arrangement: Engine and alternator are mounted on a common MS fabricated base frame with AVM pads.

Control Panel: The control panel is manufactured with 14/16 gauge CRCA sheet and is powder coated for weather-proof and long lasting finish.

The control panel consists of the following parts:

- PS0500 Controller
- Aluminum bus bars with suitable capacity with in/outgoing terminals
- Indicating lamps for 'Load On' and 'Set Running'
- Instrument fuses duly wired and ferruled
- MCCB of suitable rating with overload and short circuit protections

PS0500 Genset controller

Cummins PowerStart™ PS0500 control is a microprocessor based generator set monitoring and control system. The control provides a simple operator interface to the generator set, manual and remote start/ stop control, shutdown fault indication, and an LCD hour counter. The integration of all functions into a single control system provides enhanced reliability and performance compared to conventional generator set control systems. This control has been designed and tested to meet harsh environment in which gensets are typically applied.



Features, Functions, protections

- I 16 character x 2 line alphanumeric LCD display with LED backlight
- I Operator interface
- I Provide a record of most recent fault conditions. Fault history stored in the control non volatile memory
- I Provide Alternator Data
 - Voltage (1 ph or 3 ph line to line and line to neutral voltage)
 - Current (1 ph or 3 ph)
 - kVA (3 ph and total)
 - Frequency
- I Provide Engine Data
 - Starting battery voltage
 - Engine running hours
 - Engine Temp.
 - Engine oil pressure
- I Control includes provision for Service adjustment and calibration of DG control functions
 - Voltage, frequency selection
 - Configurable input and output set up
 - Meter calibration
- I Engine controls
 - PowerStart operates on 12 VDC batteries
 - Auto start mode accepts a ground signal from remote devices to automatically start the DG set. The remote start will also wake up the control system from sleep mode.
 - Engine Starting – The control system supports automatic engine starting, Primary and back up start disconnects are achieved by battery charging alternator feedback or main alternator output frequency.
- Controller provide configurable time delay of 0-300 secs to start

www.cumminsindia.com

Our energy working for you.™

© 2009 Cummins Power Generation Inc. All rights reserved. Cummins Power Generation and Cummins are registered trademarks of Cummins Inc. PowerCommand and "Our energy working for you." are trademarks of Cummins Power Generation. Other company product names may be trademarks or service marks of others. Specifications are subject to change without notice.

PGBU/CIL/005/B 75-140 kVA/Jaksons/February 2009/Qty.

after remote start signal and time delay of 0-600 secs prior to shutdown after stop signal.

- Sleep mode increase battery life. Configurable current settings from low to minimize current draw when genset is not working.
- I Engine Protective functions includes
 - Configurable alarm output
 - Emergency stop: Annunciated whenever an emergency stop signal is received by the control.
 - Low lube oil pressure warning and Shutdown
 - High engine water temp warning / Shutdown
 - Low coolant temp warning
 - Sensor failure indication
 - Low and high battery voltage warning
 - Weak battery warning
 - Fail to start shut down
- Cracking lockout: Control will not allow the starter to engage or to crank the running engine.
- Cyclic cranking: Configurable for the number of starting cycle (1 to 7) and duration of crank and rest periods.
- I Alternator Protective functions includes
 - High and Low AC voltage shut down
 - Under and Over frequency shutdown / warning
 - Loss of sensing voltage input shut down

Genset controller: (For 140 KVA)

Cummins **PowerCommand**® **PCC 1301** is a microprocessor based integrated generator set monitoring, metering, protection and control system with built-in torque matched Volts/Hz overload control.

Single control for all genset functions:

- Digital governing
- Digital voltage control
- Engine control
- Operator interface
- Protection
- Advanced control functions



Standard features of genset controller:

Engine		
Metering	Protection	
- RPM	- Low lube oil pressure	- Fail to crank
- Battery voltage	- High water temp.	- Fail to start
- Lube oil pressure	- High /low DC voltage	- Sensor failure
- Coolant temp.	- Weak battery	
- Running hours	- Overspeed	

Alternator		
Metering	Protection	
- 3 phase voltage (L-L and L-N)	- Under voltage	- Field overload
- 3 phase current	- Over voltage	
- Frequency	- Over current	
- kVA	- Under/ over-frequency	
	- Loss of sensing	

Others
- Battle switch function
- Delay start/ stop
- Configurable cranking cycle
- Sleep mode time



Acoustic enclosure:

The acoustic enclosure is made of 1.6/ 2 mm thick CRCA sheets in Munsel green shade and a structural/ sheet metal base frame painted in black. The walls of the enclosure are insulated with fire retardant foam so as to comply with the 75 dBA at mtr sound levels specified by Ministry of Environment & Forest.

The enclosure has the following features:

- Specially designed to meet stringent MOEF/ CPCB norms of 75 dBA @ 1mtr at 75% load under free field conditions
- Single point lifting for easy handling at customer site
- Designed to have optimum serviceability
- Air inlet louvers specially designed to operate at rated load - Made on special purpose CNC machines for consistency in quality and workmanship
- Powder coated for long lasting service life and superior finish
- With UV resistant powder coating, can withstand extreme environments

- Use of special hardware for longer life
- Insulation material meets exacting IS 8183 specifications for better sound attenuation
- Flush styling - no projections
- Fluid drains for lube oil and fuel
- Fuel filling point

Others:

- Fuel tank suitable for 8 hours of operation

Optionals

- Heavy duty air cleaner
- Microprocessor / relay based AMF control panel
- Trolley mounted mobile sets
- Cold starting kit
- Electronic governor
- Lube oil heater

Technical data

Generator set specifications

Model	CJ 75 D5 P / CJ 82.5 D5 P	CJ 100 D5 P	CJ 125 D5 P	CJ 140 D5 P
Prime Power Rating kVA / kW	75 kVA /60 kW / 82.5 kVA / 66 kW	100 kVA /80 kW	125 kVA /100 kW	140 kVA /112 kW
Current (Amps)	104 / 115	139	174	195
No. of Phases	3 Phase	3 Phase	3 Phase	3 Phase
Power Factor	0.8 (lag)	0.8 (lag)	0.8 (lag)	0.8 (lag)

Engine specifications

Make	Cummins	Cummins	Cummins	Cummins
Model	6BT5.9G1	6BTA5.9G1-I	6BTA5.9G2-I	6BTAA 5.9G1-I
BHP	105	124	154	170
Cooling	Water Cooled	Water Cooled	Water Cooled	Water Cooled
Aspiration	Turbocharged	Turbocharged Aftercooled	Turbocharged Aftercooled	Turbocharged Charged Air Cooled
No. of Cylinders	6	6	6	6
RPM	1500	1500	1500	1500
Bore (mm) x Stroke (mm)	102 x 120	102 x 120	102 x 120	102 x 120
Compression Ratio	17.6:1	17.6:1	17.6:1	17.6:1
Displacement (Ltrs.)	5.88	5.88	5.88	5.88
Fuel	HSD	HSD	HSD	HSD
Fuel Consumption (Ltr/hr) @ 75% Load with Radiator & Fan	14.3	16.9	20.8	22.9
Governor	Mechanical	Mechanical	Mechanical	Electronic
Starting System	12 V Electrical	12 V Electrical	12 V Electrical	12 V Electrical
Lube oil Specification	CF4 15W40	CF4 15W40	CF4 15W40	CF4 15W40
Lube oil Sump Capacity (Ltrs.)	14.3	14.3	14.3	14.3
Lube oil consumption (LPH)	0.04 / 0.047	0.026	0.03	0.04
Total Coolant Capacity (Ltrs.)	22	24.5	24.5	24.5
Exhaust Pipe Size (mm)	100	100	100	100
Battery Capacity / Rating	150 AH 12 V	150 AH 12 V	150 AH 12 V	150 AH 12 V

Alternator specifications

Voltage	380 / 415	380 / 415	380 / 415	380 / 415
RPM / Frequency	1500 / 50 Hz	1500 / 50 Hz	1500 / 50 Hz	1500 / 50 Hz
Enclosure	IP 23	IP 23	IP 23	IP 23
Voltage Regulation (max)	+/- 1%	+/- 1%	+/- 1%	+/- 1%
Class of Insulation	H Class	H Class	H Class	H Class
Recommended Cable size x Runs (Al Armoured 3 1/2 core)	95 x 1	120 x 1	185 x 1 or 95 x 2	240 x 1 or 120 x 2
Alternator Frame	UCI224G	UCI274C	UCI274V	UCI274E

www.cumminsindia.com

Our energy working for you.™

© 2009 Cummins Power Generation Inc. All rights reserved. Cummins Power Generation and Cummins are registered trademarks of Cummins Inc. PowerCommand and "Our energy working for you." are trademarks of Cummins Power Generation. Other company product names may be trademarks or service marks of others. Specifications are subject to change without notice.

PGBU/CIL/005/B 75-140 kVA/Jaksons/February 2009/Qty.



Conformance standards

IS 4722, BS 5000, IS 1460, ISO 8528, BS 5514, ISO 3046

Rating definitions

Prime Power (PRP):

Applicable for supplying power to varying electrical load for unlimited hours. Prime Power (PRP) is in accordance with ISO 8528. Ten percent overload capability is available in accordance with ISO 3046, AS 2789, DIN 6271 and BS 5514.

Emergency Standby Power (ESP):

Applicable for supplying power to varying electrical load for the duration of power interruption of a reliable utility source. Emergency Standby Power (ESP) is in accordance with ISO 8528. Fuel Stop power in accordance with ISO 3046, AS 2789, DIN 6271 and BS 5514.

- Fuel consumption data is based on diesel having specific gravity of 0.85 and conforming to IS:1460
- Oil consumption data is based on oil having specific gravity of 0.89 and meeting CF4 API categories
- Fuel consumption tolerance is +5%

Typical enclosed genset dimensions*

Genset Model	Rating (kVA)	Length (mm)	Width (mm)	Height (mm)
CJ 75 D5 P / CJ 82.5 D5 P	75 kVA / 82.5 kVA	3850	1150	1700
CJ 100 D5 P	100 kVA	4000	1150	1700
CJ 125 D5 P	125 kVA	4000	1150	1700
CJ 140 D5 P	140 kVA	4000	1150	1700

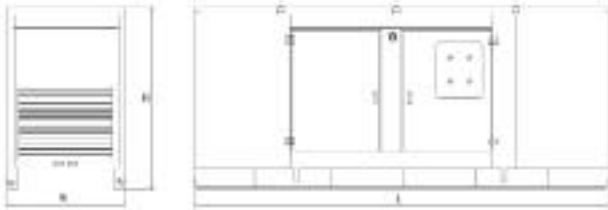

Cummins India Limited

Power Generation Business Unit
35A/1/2, Erandawana,
Pune 411 038. India
Tel.: (91) 020-6602 7525 Fax: (91) 020-6602 8090

Cummins Power Generation Offices:

Location:	Tel:	Fax:
Bangalore:	(080) 2361 3831/ 2361 1958	(080) 2361 4552
Chandigarh:	(0172) 2240373	(0172) 224 0371
Chennai:	(044) 2446 8110/ 2446 8113	(044) 2491 1120
Delhi:	(011) 4161 8357/ 61	(011) 4161 8357/ 61
Hyderabad:	(040) 2766 3017	(040) 2767 8892
Indore:	(0731) 645 1042/ 09826 42717	
Jaipur:	(0141) 236 4944	(0141) 403 8794
Kolkata:	(033) 2287 8065/ 2247 2481	(033) 2290 3839
Lucknow:	(0522) 278 6718/ 278 8959	(0522) 278 7880
Mohali:	(0172) 224 0373	(0172) 224 0371/ 72
Mumbai:	(022) 2756 6351/ 52/ 53/ 54	(022) 2756 6355
Vadodara:	(0265) 232 4207/ 654 0390/	(0265) 308 3010

Jaksons Limited

A-43, Phase-II (Extn.), Opp. NEPZ,
Noida - 201305 (U.P.)
Tel: (0120) 430 2600/ 256 8923-27 Fax: (0120) 430 2646/ 256 8930
Email: contact@jakson.com
Website: www.jakson.com

Jaksons Ltd. - Regional and Branch Offices:

Location:	Tel:	Fax:
Allahabad	(M) 9839210580	
Bareilly	(M) 9319258525	
Bhubaneshwar	(0674) 254 0905/ 254 0906	(0674) 254 0905
Daman	(M) 9726011999	
Gorakhpur	(M) 9839705110	
Guwahati	(0361) 260 2970 (M) 9954098818	
Haridwar	(M) 9837017868	
Indore	(0731) 404 2011 (M) 9755559036	(0731) 252 6456
Jamshedpur	(M) 9334445567	
Kanpur	(0512) 230 4677/ 230 3499	(0512) 230 4634
Kolkata	(M) 9339796316	(033) 6633 5800
Lucknow	(M) 9839110134	
Mathura	(M) 9319603567	
Meerut	(M) 9319447530	
Mumbai	(022) 2766 4454/ 2780 2383	(022) 2765 0294
New Delhi	(011) 6545 7616/ 17	(011) 2575 3427
Noida	(0120) 430 2600/ 2568923-27	(0120) 4302646
Raipur	(M) 9300205447	
Rudrapur	(M) 9837058611	
Varanasi	(M) 9839241506	

Authorised
Representative

www.cumminsindia.com

Our energy working for you.™